

Especificaciones Técnicas

Sección de Marco	40 mm.
Sección de Hoja	40 mm.
Lama Fija	50 mm.
Lama Móvil	66 y 71 mm.
Galce de vidrio	de 8.5 a 32 mm.

Posibilidades de Apertura

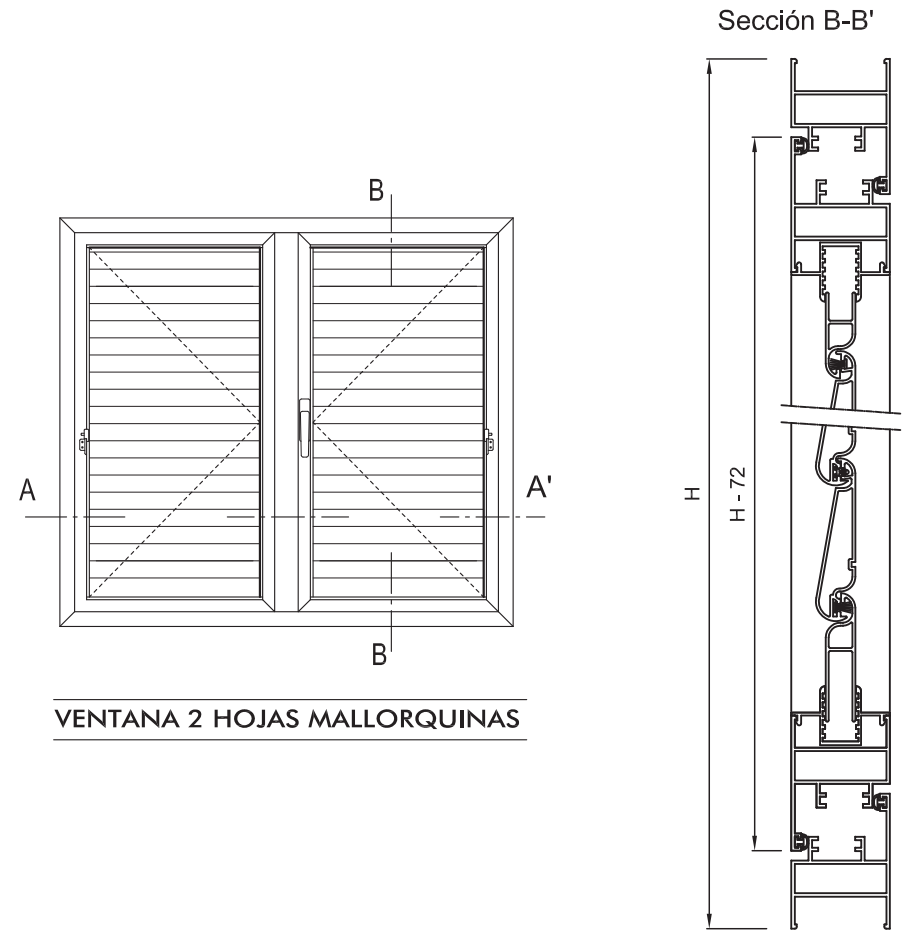
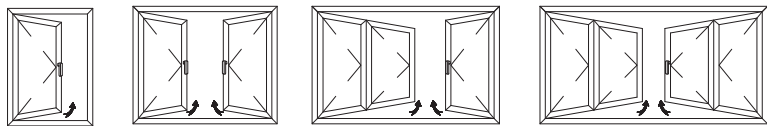

VENTANA 2 HOJAS MALLORQUINAS

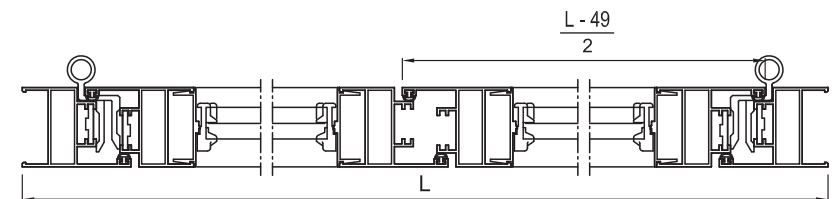

Sección A-A'

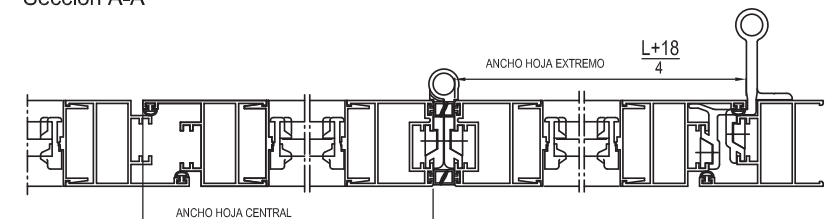

Sección lateral de ventana de 4 hojas

Perfiles

Universal UN-55

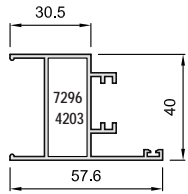

S8301 (8301)

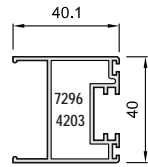

S8311 (8311)

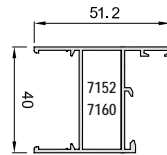

3781 (138)

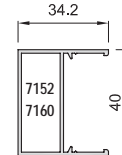

3782 (364)

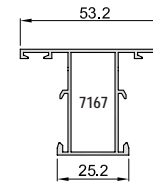

3720

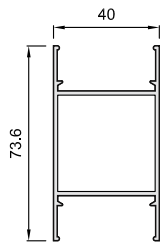

S8315 (8315)

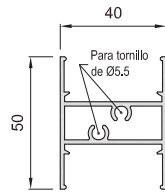

S8317 (8317)

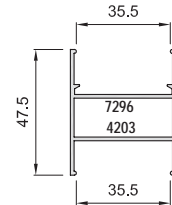

S8316 (8316)

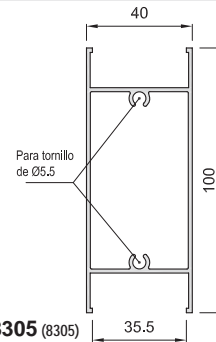

S8305 (8305)

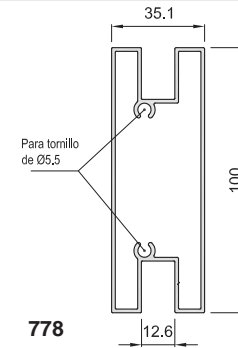

778

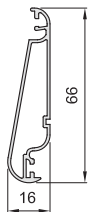

S8312 (8312)

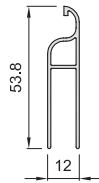

S8314 (8314)

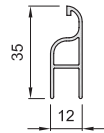

S8313 (8313)

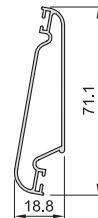

175



177



178



S8309 (8309)

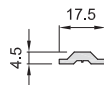

110



8412

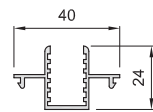

S8302 (8302)

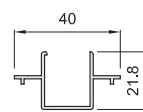

S8310 (8310)

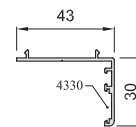

3777

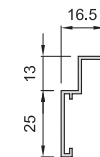

S8308 (8308)

Accesorios Universal UN-55

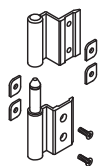

4205
Bisagra
universal Acero

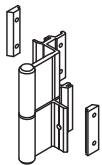

4244
Bisagra extremo
4 Hojas

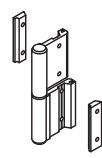

4245
Bisagra H./H.
4 Hojas

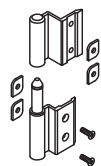

4452
Bisagra
Universal Inox.

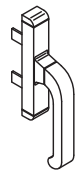

4200
Cremona Nova



4201
Kit Cremona
Nova Ap. Interna

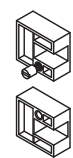

4202
Kit Cremona Nova
Ap. Externa



4002
Pasador oculto
long. variable



4740
Pasador hoja
pasiva metálico



4451
Juego pasadores
canto 4 Hojas



4003
Terminal de
pletina cremona



4739
Terminal pletina
metálico

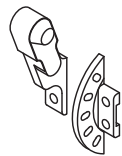

4246
Mando Standard



4247
Mando Esfera

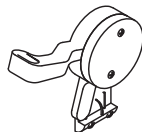

4248
Mando Jirafa



4268
Cierre lama
movil extraplano



4009
Cierre de
cangrejo Interno



4010
Bisagra compás
corto ralenti



4085
Bisagra compás
largo ralenti



4011
Bisagra compás
regulable



4007
Cierre compl.
cremona



4005
Cerradero lateral
pletina (NYLON)



4204
Cerradero central
plet. cremona

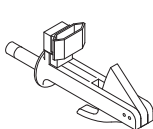

4240
Mecanismo de
fijación pared

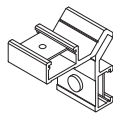

4203
Escuadra cerco
y hoja



7296 (3627)
Escuadra pulsante
ven. t. descentra.

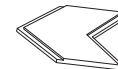

4304
Escuadra alineami.
solapas



4391
Escuadra junquillos
curvos



4078
Pieza sujeción
junquillo curvo clip

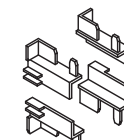

4241
Juego terminación
nudo central

Ver Instrucciones de Montaje de las Celosías

TABLA DE CELOSIAS					
REF.	Nº DE LAMAS	* A (mm.)	REF.	Nº DE LAMAS	* A (mm.)
4209	UN55 6 LAMAS	395-450	4223	UN55 20 LAMAS	1165-1220
4210	UN55 7 LAMAS	450-505	4224	UN55 21 LAMAS	1220-1275
4211	UN55 8 LAMAS	505-560	4225	UN55 22 LAMAS	1275-1330
4212	UN55 9 LAMAS	560-615	4226	UN55 23 LAMAS	1330-1385
4213	UN55 10 LAMAS	615-670	4227	UN55 24 LAMAS	1385-1440
4214	UN55 11 LAMAS	670-725	4228	UN55 25 LAMAS	1440-1495
4215	UN55 12 LAMAS	725-780	4229	UN55 26 LAMAS	1495-1550
4216	UN55 13 LAMAS	780-835	4230	UN55 27 LAMAS	1550-1605
4217	UN55 14 LAMAS	835-890	4231	UN55 28 LAMAS	1605-1660
4218	UN55 15 LAMAS	890-945	4232	UN55 29 LAMAS	1660-1715
4219	UN55 16 LAMAS	945-1000	4233	UN55 30 LAMAS	1715-1770
4220	UN55 17 LAMAS	1000-1055	4234	UN55 31 LAMAS	1770-1825
4221	UN55 18 LAMAS	1055-1110	4235	UN55 32 LAMAS	1825-1880
4222	UN55 19 LAMAS	1110-1165			

* Altura libre de hueco de hoja



4453
Taco tipo
lama fija "Z"

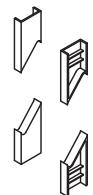

4454
Taco compensador
lama fija "Z"



4455
Posicionador fijo
cierre total



4456
Posicionador fijo
apertura 60°

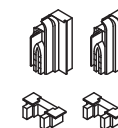

4457
Compensador
extremo

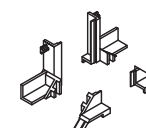

4249
Juego terminación
hoja/hoja/ 4 H.



4208
Goma ajuste entre
lamas



4259
Goma unión vert.
entre hojas



4258
Goma exterior
cerco



4260
Goma estanqu.
Horizontal hojas



4281
Goma estanqu. Hor.
hojas base rígida



4450
Felpudo lama
inicial y final

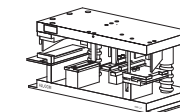

4239
Util serie Universal