

PUERTA TIPO DE APERTURA EXTERIOR E INTERIOR INCLUSO DE VAIVÉN

Carpintería practicable sin rotura de puente térmico, los perfiles de cerco y hoja tienen una profundidad de 53 mm. Dicho sistema posibilita aperturas practicables de una y dos hojas, tanto al interior como al exterior, pudiéndose realizar múltiples composiciones de puertas y fijos..

CARACTERÍSTICAS TÉCNICAS.

Carpintería practicable de cámara Europea

- Sección de marco: 53 mm.
- Sección de hoja: 53 mm.
- Máximo acristalamiento: hasta 32 mm.

CLASIFICACIÓN OBTENIDA.

Resistencia al impacto de cuerpo blando **CLASE 5*** UNE EN 13049:2003 y UNE EN 14019:2004

* Puerta de 2 hojas de 1600 x 2200 mm.

SECCIÓN 2D

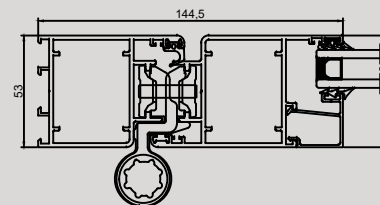

PESOS Y MEDIDAS MÁXIMAS

- Apertura Practicable:
Peso por hoja: 180 Kg



IMAGEN 3D

POSIBILIDADES DE APERTURA



SECCION B - B'

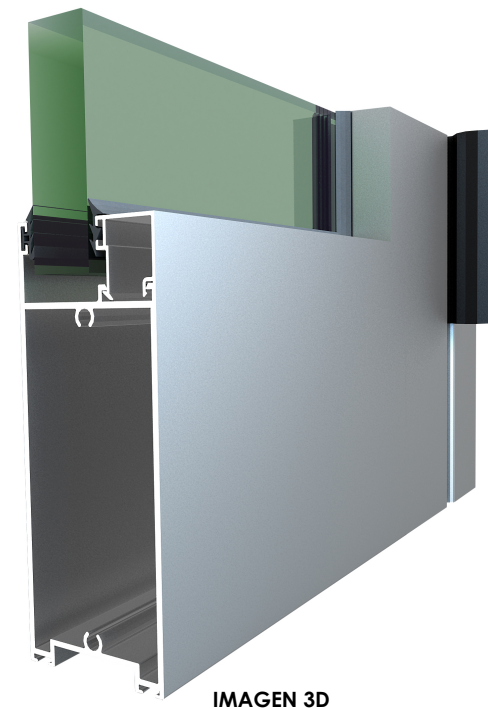
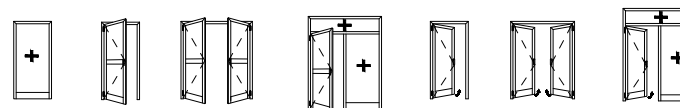
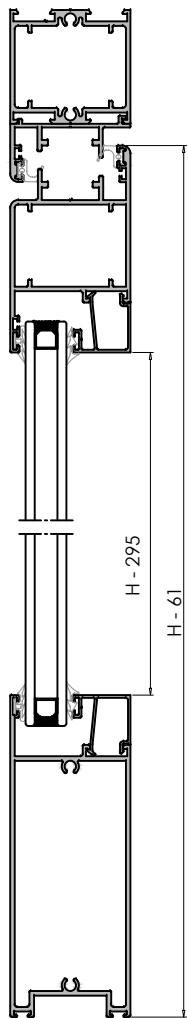

PERFIL	Ref. ^o / DENOMINACION		Uds. / Corte		
	S8170	MARCO PUERTA	1 L	2 H	
	S8171	HOJA PUERTA	2 (L - 69) / 2	4 H - 63	
	S8173	INVERSION 2 HOJAS	1 H - 129		
	S8177	ZÓCALO PUERTA	2 H - 129		
	Según Vidrio	JUNQUILLO	4 (L - 337) / 2	4 H - 237	

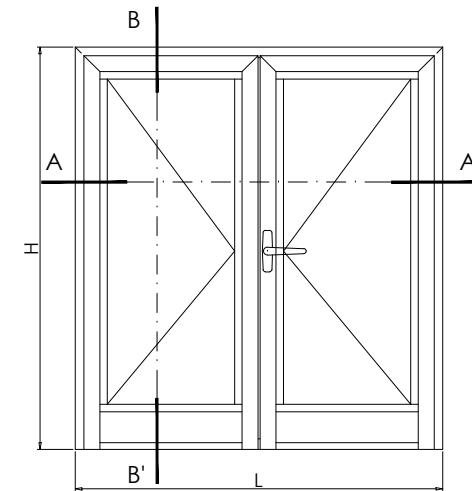

SECCION A - A'

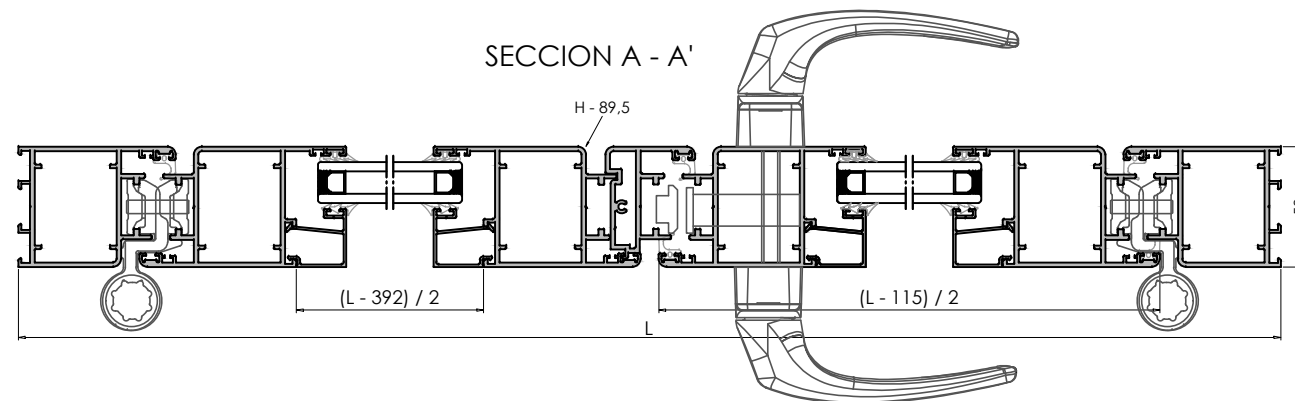

SECCION B - B'

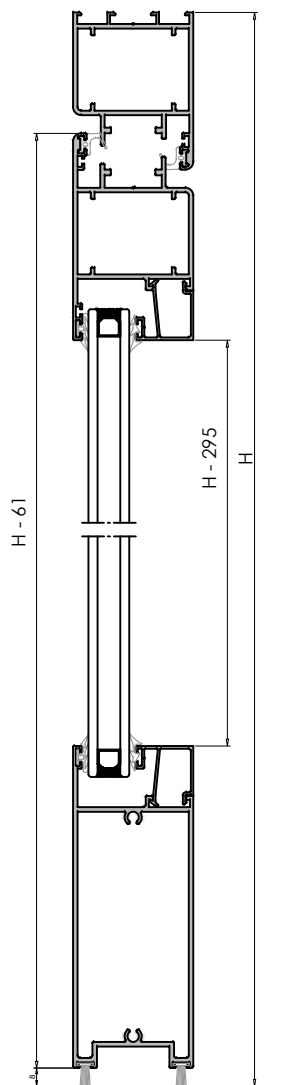

PERFIL	Refª. / DENOMINACION		Uds. / Corte		
	S8170	MARCO PUERTA	1	L	
			2	H	
	S8172	HOJA AP. EXTERIOR	2	$(L - 115) / 2$	
			4	H - 61	
	S8173	INVERSOR 2 HOJAS	1	H - 89,5	
	S8177	ZÓCALO PUERTA	2	H - 129	
	Según Vidrio	JUNQUILLO	4	$(L - 392) / 2$	
			4	H - 295	

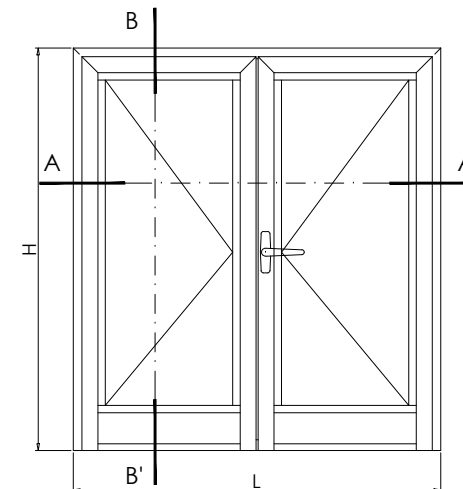

SECCION A - A'

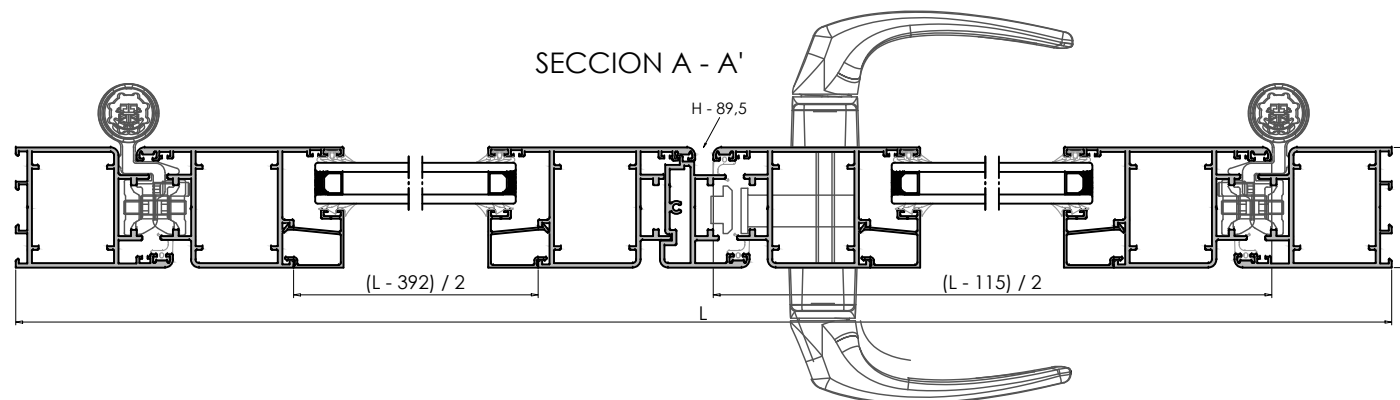

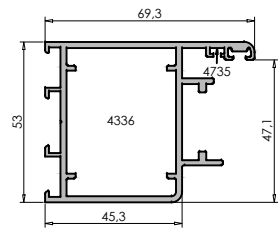

S8170
(8170)

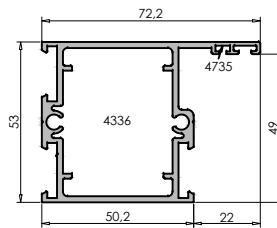

S8179
(8179)

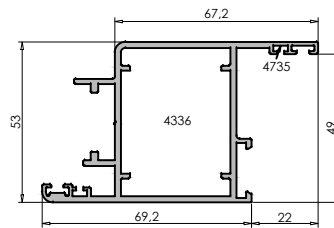

S8171
(8171)

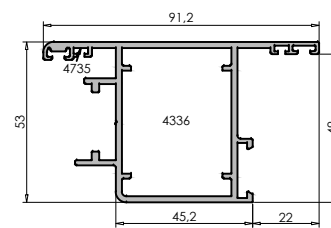

S8172
(8172)

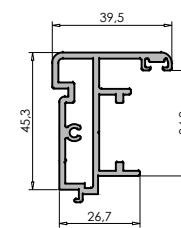

S8173
(8173)

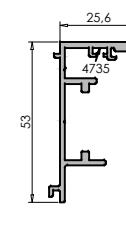

S8174
(8174)

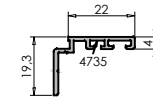

S8175
(8175)

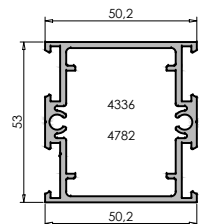

S8176
(8178)

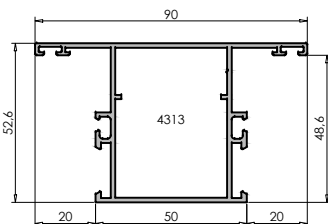

S8473
(8473)

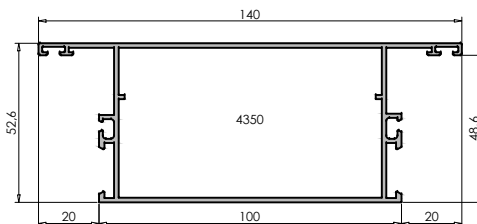

S8499
(8499)

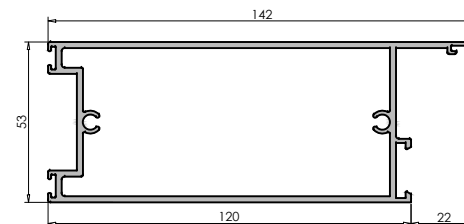

S8177
(8177)

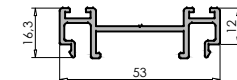

S8178
(8178)

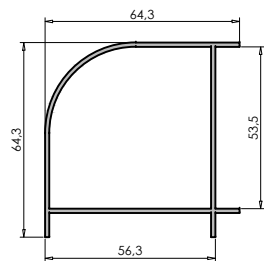

S8457
(8457)

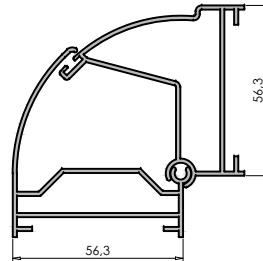

S8478
(8478)

S8478
(8478)

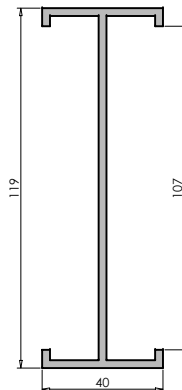

S8440
(8400)

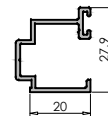

S8891
(8891)

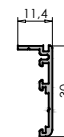

2181
(281)

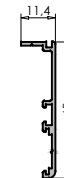

S8629
(8629)

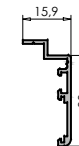

S8832
(8832)



S8630
(8630)

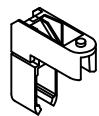

4336
ESCUADRA MARCO/HOJA



4735
ESCUADRA ALINEAMIENTO 2 mm



4730
TACO PILASTRA STILO ANCHA



4313
TACO PILASTRA STILO MEDIANA

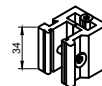

4782
TACO TRAVESAÑO SIMÉTRICO

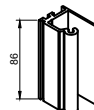

4350
TACO STILO MANGETÓN



4035
EMBELCEDOR SALIDA DE AGUA



4337
EMB. SALIDA DE AGUA C/MEMBRANA

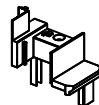

4775
TAPA INVERSOR DCH. STILO PUERTA

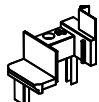

4776
TAPA INVERSOR IZD. STILO PUERTA



4078
GRAPA JUNQUILLO



7216
ÁNGULO JUNQUILLO



4777
JUNTA PERIMETRAL HOJA



4973
FELPUDO FEAM-SEAL 7x10 + 2 mm



4770
BISAGRA RAPIDOM 2 ALAS

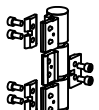

4771
BISAGRA RAPIDOM 3 ALAS

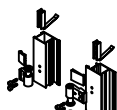

4026
BISAGRA PUERTA APERT. INTERNA



4027
BISAGRA PUERTA APERT. EXTERNA

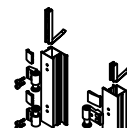

4028
BISAGRA 3 ALAS APERT. INTERNA

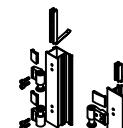

4029
BISAGRA 3 ALAS APERT. EXTERNA

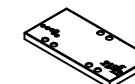

4308
PLANTILLA BISABRA 61 mm

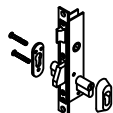

7310
CERRADURA DE SEGURIDAD
(PALAS, +RESB O ROD.)



4779
DINTEL DE SUELO EMPOTRADO



4778
PASADORES HOJA PAS. STILO PUERTA



7306
CERRADURA SEGURIDAD 3 PUNTOS