



Serie

Silver - 65 RPT

Especificaciones Técnicas

Carpintería Corredera

Cerco y Hoja Perimetral

Sección de Marco 65 mm.

Sección de Hoja 28 x 74,5 mm.

Galce de vidrio hasta 24 mm.

Peso Máximo por Hoja : 100 Kg. (2 tándems por hoja)⁽¹⁾

Posibilidad de colocación de Herraje Multipunto Corredera

(1) No recomendable hacer balconeras de grandes dimensiones

Clasificación obtenida

Permeabilidad al aire*	CLASE 3
Estanqueidad al agua*	CLASE 7A
Resistencia al viento*	CLASE C5
Transmitancia térmica**	2,1 W(m ² K)
Aislamiento acústico***	31 (-1;-4)dB

* Ventana de 2 hojas de 1230 x 1480 mm.

** Ventana de 2 hojas de 1230 x 1480 mm ; Vidrio Uv: 1,0 W(m²K)

*** Ventana de 2 hojas de 1230 x 1480 mm ; Vidrio Rw: 40 (-2,-6)dB

Posibilidades de Apertura

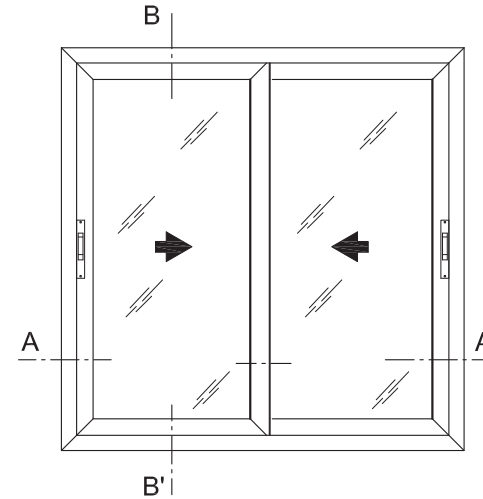
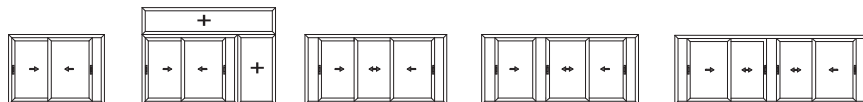

VENTANA DE 2 HOJAS CORREDERAS

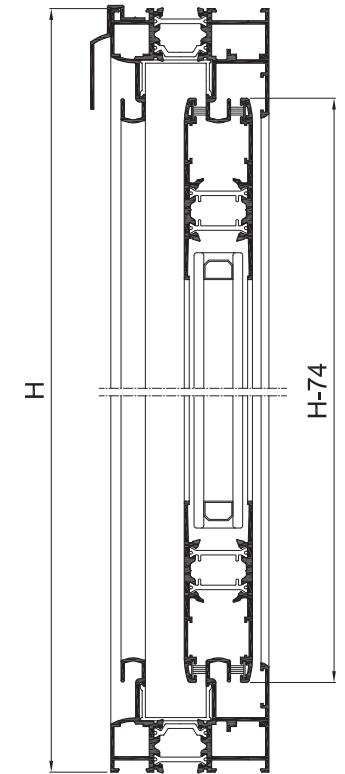

Sección B-B'

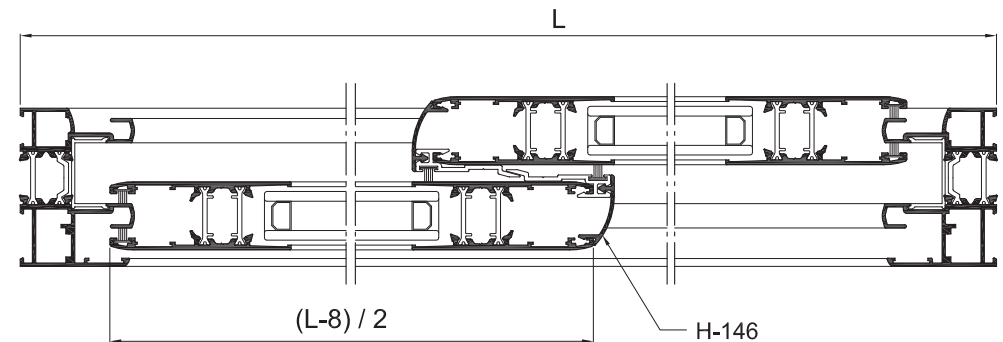

Sección A-A'

Perfiles

Silver - 65 RPT

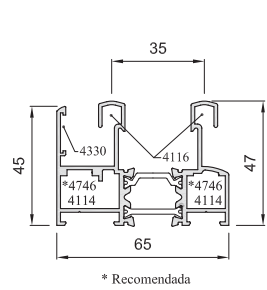

S1000 (10000M)

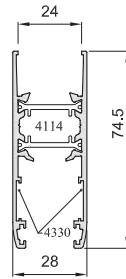

S1002 (10002M)

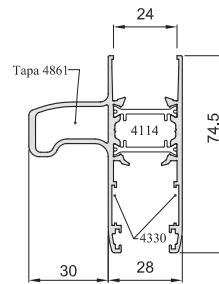

S1007 (10007M)

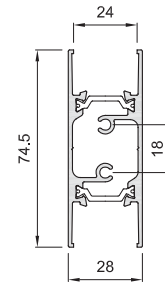

S1005 (10005M)

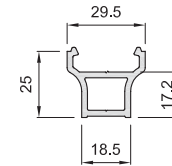

783

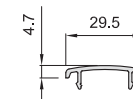

784

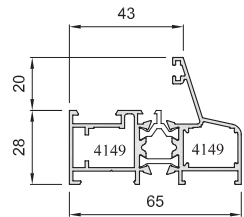

S8897 (8897)

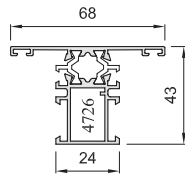

S8865 (8865M)

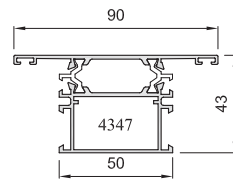

S8810 (8810M)

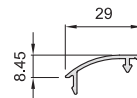

S1004 (10004M)

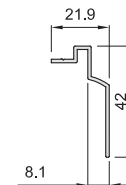

S1003 (10003M)

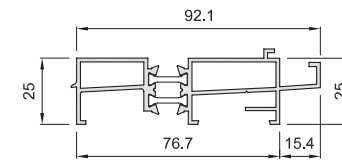

S8619 (8619M)

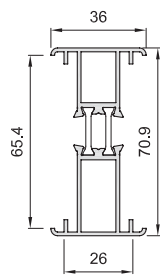

S8097 (8097M)

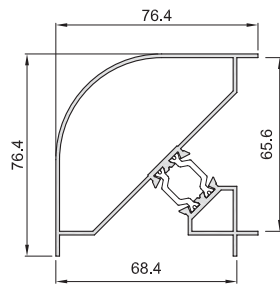

S1006 (10006M)

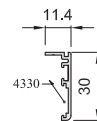

2181 (281)

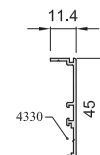

S8629 (8629)

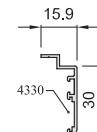

S8832 (8832)

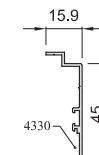

S8630 (8630)

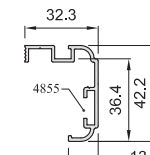

S8893 (8893)



Accesorios

Silver - 65 RPT

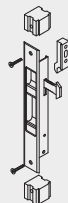

4550
Cierre Embutido
grande s/condena

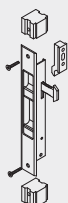

4557
Cierre embutido
grande c/condena

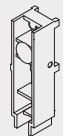

4108
Tope Guiador
(Jgo. 4)

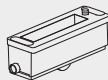

4101
Rueda regulable
Sencilla
(2 uds. 50 kg. por hoja)

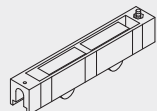

4103
Rueda regulable
Tandem
(2 uds. 100 kg. por hoja)



4106
Embellecedor cruce
central
(Jgo.4)

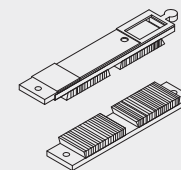

4105
Juego cortavientos
desmontable



7792
Felpudo Fean Seal
7 x 6 mm.



4176
Valvula de
drenaje



4746
Escuadra Cerco y Hoja



4114
Escuadra Cerco y Hoja
(Botón alto)



4149
Escuadra fijo
(ala inclinada)



4330
Escuadra
alineamien. 15 mm.



4735
Escuadra
alineam. 2 mm.



4116
Escuadra alineamiento
carriles



4110
Perfil aislante
cerco



4111
Perfil aislante
acople central



4112
Perfil aislante
acople 4 hojas

CIERRE MULTIPUNTO E: 7.5 mm

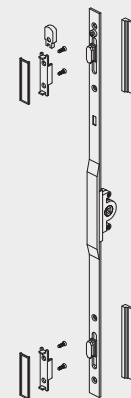

4187
Cierre multipunto
H= 668 - 1068

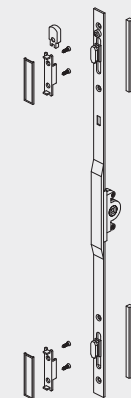

4188
Cierre multipunto
H = 1069-1868

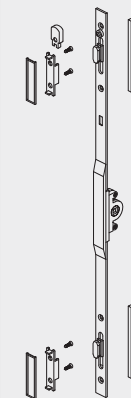

4189
Cierre multipunto
H > 1869

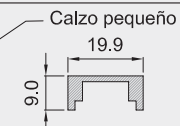

4190
Manilla
cuadrado 7 mm.



4858(D) / 4859(I)
Manilla corredera
acodada
cuadrado 7 mm.

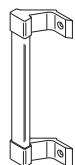

7349 (4153)
Tirador grande



4861
Juego terminales
hoja reforzada

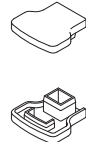

4339
Juego tapas
tirador postizo
(783-4)



4855
Escuadra solapa 8893

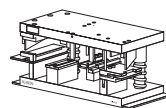

4113
Util multiple
Silver-65 rpt