

# Barandilla

Sección Vertical

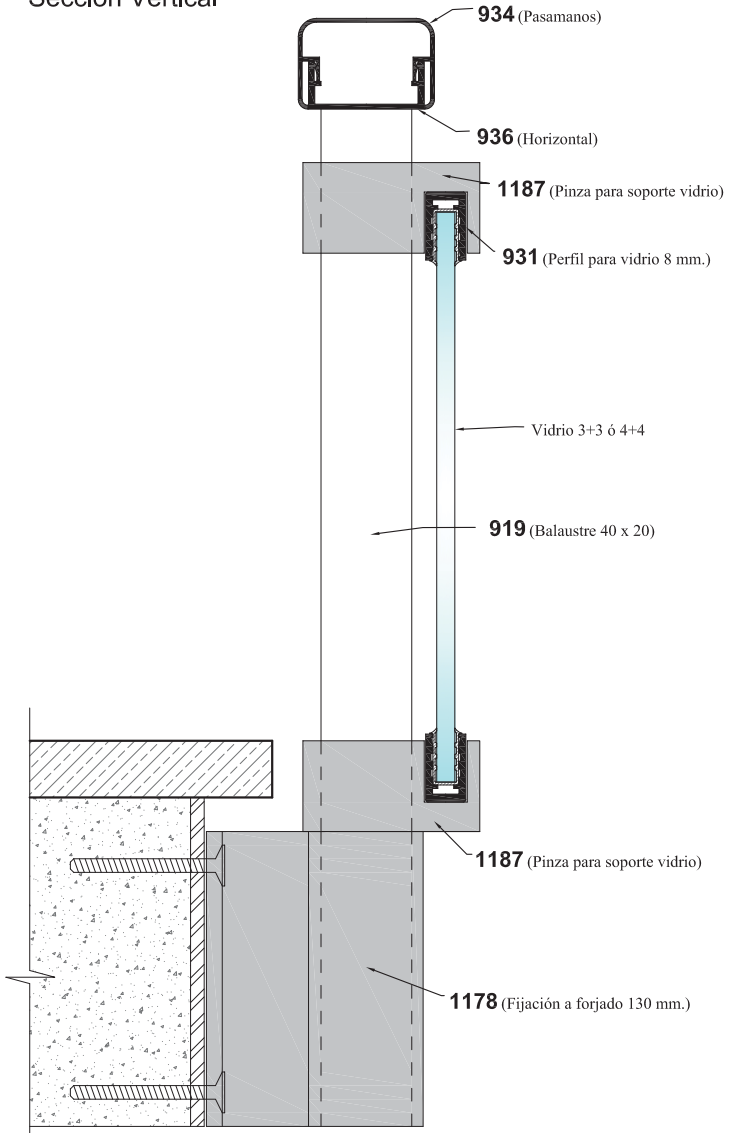

## Perfiles

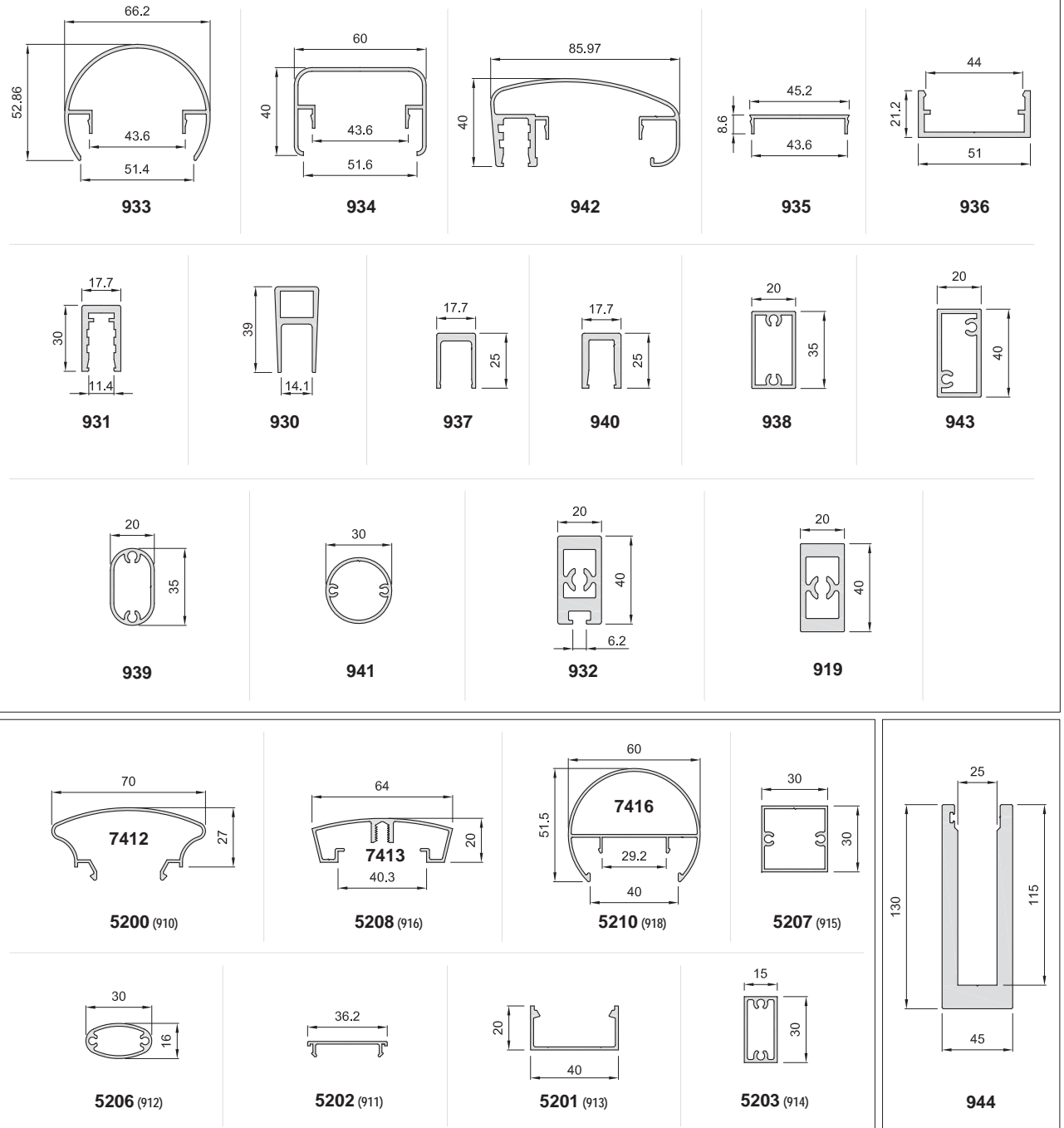

# Accesorios

## Barandilla



**1170**

Tapa Pasamanos  
Nylon para  
cuadrado



**1171**

Tapa Pasamanos  
Nylon para  
redondo



**1172**

Tapa Pasamanos  
Aluminio para  
cuadrado



**1173**

Tapa Pasamanos  
Aluminio para  
redondo

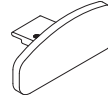

**1711**

Tapa para  
Pasamanos (942)

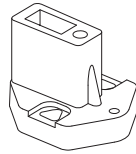

**1174**

Pié-anclaje a  
suelo fundición

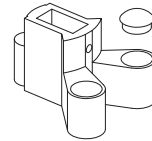

**1175**

Pié-anclaje a  
suelo extrusión

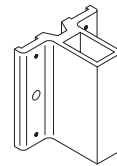

**1176**

Fijación corta a  
forjado para tubo  
40 x 20

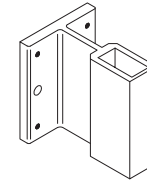

**1177**

Fijación de 100 a  
forjado para tubo  
40 x 20

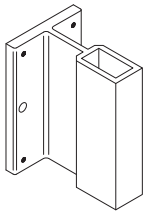
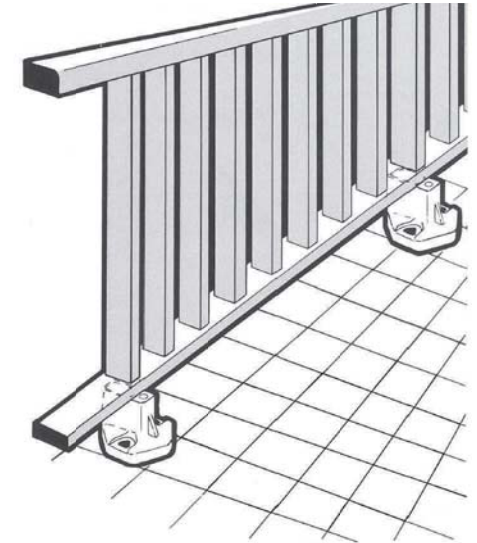

**1178**

Fijación de 130 a  
forjado para tubo  
40 x 20



**1179**

Terminal  
Izquierdo para  
travesaño 40 x 20

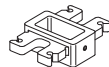

**1181**

Terminal central  
para travesaño  
40 x 20



**1182**

Terminal Derecho  
para travesaño  
40 x 20

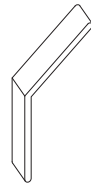

**1183**

Escuadra para  
93

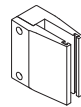

**1184**

Pinza para vidrio  
directo

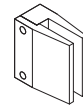

**1185**

Pinza para vidrio  
o panel



**1186**

Escuadra para  
930

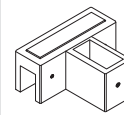

**1187**

Pinza para vidrio  
pasante

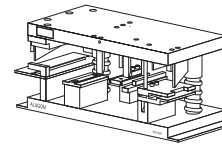

**1198**

Util Barandilla

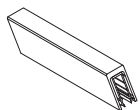
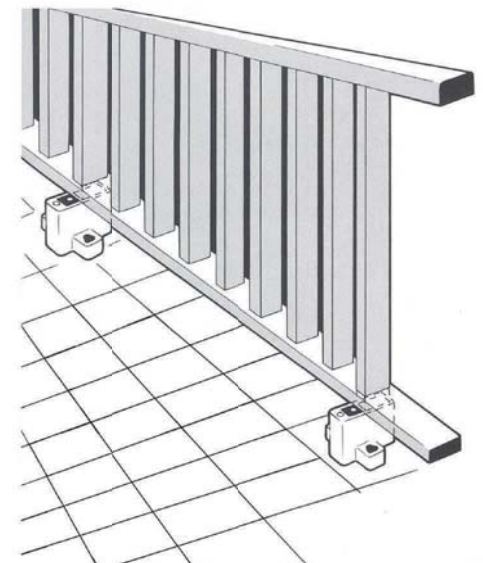

**1154**

Perfil + junta  
para vidrio a 30°  
(937+1188)



**1188**

Junta junquillo  
para vidrio 8-11  
mm.

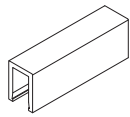

**1199**

Portavidrio para  
8 mm.



**1189**

Fijación pared 110  
desplazamiento



**1190**

Fijación pared 80  
desplazamiento



**1191**

Escuadra 90°



**1192**

Escuadra ángulo  
variable



**1193**

Escuadra compás

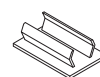

**1194**

Tapón aluminio  
para anclaje  
(1176, 1177, 1178)

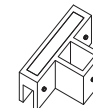

**1195**

Soporte vidrio  
30° IZDA.  
pasante

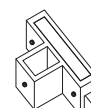

**1196**

Soporte vidrio  
30° DECHA.  
pasante